

IBCO# ER 5045
**INSTALLATION
 INSTRUCTIONS**

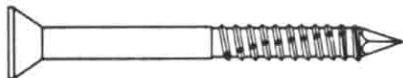
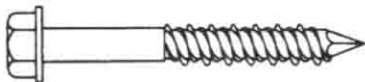

POWER-CON™ features

Hi-Lo thread design:

- Taps its own thread and eases installation*
- Increases pullout values

ENVIRO-COAT™

- Special 1,500-hour salt spray tested, blue ENVIRO-COAT™ plating offers optimum corrosion resistance.

Other benefits:

- Available in hex head and phillips flat head.
- Made with hardened steel.
- No sleeve or shield required
- Diamond tip penetrates hard materials
- ICBO licensed for quality assurance

*Pilot hole necessary for correct installation.
 Drill bit sold separately.

CAUTION:

Hardened carbon steel meets or exceeds industry standards. However, the effects of galvanic corrosion should be considered if they are used with aluminum or when moisture may be present.

POWER-CON™ Concrete Screw Anchors must be installed with special tolerance masonry drill bits.

Attached Fixture	Hole Depth	Screw Length	Bit Length
A	B	C	
0 - 1/4	1 1/2	1 1/4	3 1/2
1/4 - 3/4	2	1 3/4	3 1/2
3/4 - 1 1/4	2 1/2	2 1/4	4 1/2
1 1/4 - 1 3/4	3	2 3/4	4 1/2
1 3/4 - 2 1/4	3 1/2	3 1/4	5 1/2
2 1/4 - 2 3/4	4	3 3/4	5 1/2
2 3/4 - 3	4 1/4	4	5 1/2

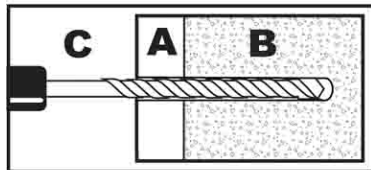

1. Using the proper diameter POWER-CON™ bit, drill a hole into the base material to at least a 1/2" deeper than the fastener embedment. Carbide tipped masonry drill bits must be used. Clean the hole of any dust or debris.

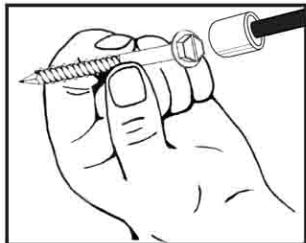

2. Select the POWER-CON™ Concrete Screw Anchor to be used. Insert the anchor into the hex head socket or Phillips head driver. For softer concrete or masonry, set motor to the "rotation only" mode.

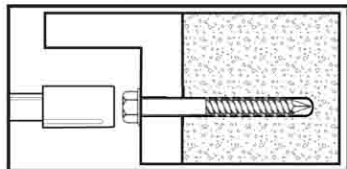

3. Place the point of the POWER-CON™ Concrete Screw Anchor through the designated material, into the pre-drilled hole, and drive the anchor until it is fully seated at the proper embedment.